



# PVC AND CPVC SCHEDULE 40 & 80 ASTM FITTINGS

FOR POTABLE WATER AND SEWAGE SYSTEMS



NEW PRODUCTS INDUSTRIES CO. LTD



Distributed by  
National Marketing Est. Co. Ltd

## Certificate of Registration

**Intertek**



This is to certify that the Quality Management System of

### New Product Industries Co. Ltd.(NEPROPLAST)

P.O. Box 460, Jeddah 21411, Kingdom of Saudi Arabia

has been assessed and registered by MICL as conforming to the requirements of

**ISO 9001: 2008**

The Quality Management System is applicable to

The manufacture of upvc & cpvc plastic pipes & fittings and hdpe plastic pipes.

Certificate Number 27050  
Initial Certification Date 20 September 2012  
Certificate Expiry Date 19 September 2015

*Colin Johnson*

Colin Johnson, President  
Moody International Certification Ltd (UK Intertek) is a UKAS accredited body under schedule of accreditation no. 254

In the issuance of this certificate, Intertek assumes no liability to any party other than the Client, and then only in accordance with the agreed upon Certification Agreement. This certificate's validity is subject to the organisation maintaining their system in accordance with Intertek's requirements for system certification. Validity may be confirmed via email at [cert@uk.intertek.com](mailto:cert@uk.intertek.com) or by scanning the code to the right with a smartphone.



MOODY INTERNATIONAL CERTIFICATION

New Product Industries Co.Ltd

**NEPROPLAST**

P.O.Box-460, Jeddah - 21411

Kingdom of Saudi Arabia

BS EN ISO 9001:2000

SCOPE OF REGISTRATION:

The Manufacture of uPVC and CPVC Plastic Pipes and Fittings

CERTIFICATE NO: 27050

Subject to continued compliance with ISO 9001 and the Moody International Certification Scheme Rules and Regulations, your certificate of which scope of Registration document is part is valid indefinitely

Further Clarification regarding the scope of this certificate and the applicability of ISO 9001:2000 requirements may be obtained by consulting the above Organisation

While all due care and skill was exercised in carrying out this audit, Moody International Certification Ltd. accepts responsibility only for proven gross negligence.

*Subscribed that this is a copy of the original certificate issued by Moody International*

*20/09/2012*  
*(Baw power)*

**NSF** Live safer.®

Close window to exit NSF Listings.

### NSF Product and Service Listings

These NSF Official Listings are current as of **Monday, June 18, 2012** at 12:15 a.m. Eastern Time. Please [contact NSF International](http://www.nsf.org) to confirm the status of any Listing, report errors, or make suggestions.

Alert: NSF is concerned about fraudulent downloading and manipulation of website text. Always confirm this information by clicking on the below link for the most accurate information: <http://www.nsf.org/Certified/PwsComponentsAListings.asp?Company=C00269658&Standard=6616>

### NSF/ANSI STANDARD 61 Drinking Water System Components - Health Effects

NOTE: Unless otherwise indicated for Materials, Certification is only for the Water Contact Material shown in the Listing. [Click here for a list of Abbreviations used in these Listings.](#)

#### New Products Industries Co., Ltd. (Neproplast)

Jeddah Industrial City, Phase 3  
P.O. Box 460  
Jeddah 21411  
Saudi Arabia  
966 26363558  
[Visit this company's website](#)

Facility : Jeddah, Saudi Arabia

# INTRODUCTION

To attain the highest standard quality for Fittings, NEPROPLAST is keen to be associated with the world pronounced leader of raw materials manufactures, to produce its PVC Fitting and its licensed FlowGuard™ cPVC Fittings. NEPROPLAST products are maintained throughout the operation by a Quality Assurance System based on ISO 9001:2008 covering both the raw materials and finished products, which guarantee, the right materials for Hot and Cold water installations demanding safe, tough and reliable systems. NEPROPLAST has been assessed and certified by moody International Certification body of Germany for its Quality Management system to International Quality system standard EN ISO 9001:2000 . NEPROPLAST manufactured FlowGuard™ cPVC & PVC Fittings are tested, approved and listed by NSF/ANSI 61 (USA) an “Approved product for use with drinking water”.

## Materials:

NEPROPLAST PVC & FlowGuard™ cPVC Fittings are Manufactured in the Kingdom of Saudi Arabia from Compounds approved for Drinking Water by NSF (USA) & WRC (UK). Fully meeting or exceeding the requirements of ASTM Materials and dimensional standards. Compounds are meeting requirements specified in Table - 1.

## Markings:

NEPROPLAST PVC & FlowGuard™ cPVC Fittings are marked as prescribed in the ASTM Standard indicating manufacture name standard, size, type & NAMAT Logo, or pipe thread size.

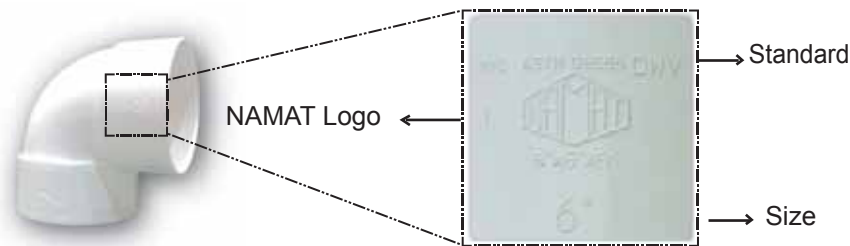

## Applications:

NEPROPLAST PVC & CPVC FlowGuard™ Fittings are suitable for hot and cold drinking water systems and can be utilized in commercial and industrial plumbing applications (in which metals Fittings will not tolerate the reactive effect of chemicals and corrosive materials), Cooling water, plants distribution lines, Chemical and wastewater systems, Acid products handling for refineries, metal works and plating plants, bleach, dye and acid lines in textile mills, deionized water, piping for the dairy, canning and beverage industries, chlorine injection systems. etc.

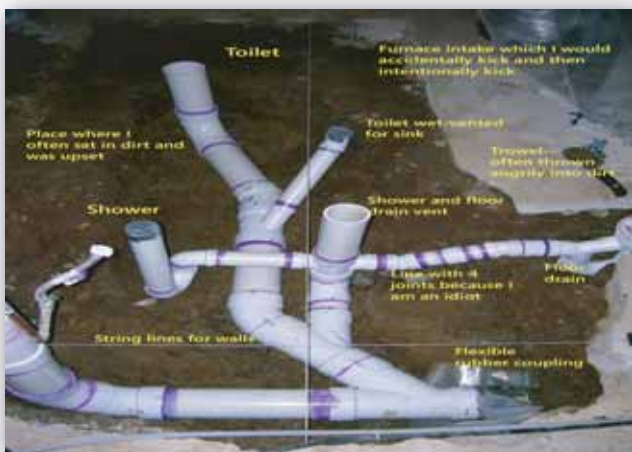

# STANDARDS AND DIMENSIONS

**Table - 1**

Schedule 40 PVC Fittings	Material
ASTM - D - 1784 Rigid Poly Vinyl Chloride (PVC) Compound. ASTM - D - 2466 Rigid Poly Vinyl Chloride (PVC) Plastic Pipe Fittings Schedule 40.	Produced from PVC type 1, cell Classification 12454 - B
Schedule 40 DWV PVC Fittings	
ASTM - D 2665 and D 3311	Produced from PVC type 1, cell Classification 12454 - B
Schedule 80 PVC Fittings	
ASTM - D- 2467 Socket type Rigid Poly Vinyl chloride (PVC) Plastic Pipe Fittings Scheduled 80. ASTM - D - 2464 Threaded Rigid Poly Vinyl chloride (PVC) Plastic Pipe Fittings Scheduled 80 ASTM - D - 1784 Rigid Poly Vinyl Chloride (PVC) Compound and Chlorinated PolyVinyl Chloride (CPVC) compound. ANSI - B 2.1 - Threaded fittings and pipe.	Produced from PVC type 1, cell Classification 12454 - B
Schedule 80 CPVC Fittings	
ASTM - F - 439 Socket type Chlorinated Poly Vinyl chloride (PVC) Plastic Piping Fittings Scheduled 80. ASTM-F-437 Threaded type Chlorinated Poly Vinyl chloride (PVC) Plastic Piping Fittings. Scheduled 80. ASTM -D - 1784 Rigid Poly Vinyl Chloride (PVC) Compound and Chlorinated Poly Vinyl Chloride (CPVC) compound.	Produced from CPVC material meeting ASTM cell classification 23447- B

**Color:**

Schedule 40 PVC FITTINGS- White  
Schedule 80 PVC FITTINGS- Dark Grey  
Schedule 80 CPVC FITTINGS- Light Grey

**Operating Temperature:**

Schedule 40 and Schedule 80 PVC FITTINGS are operated at maximum service temperature of 140°F  
Schedule 80 CPVC fittings are operated at maximum service temperature of 210°F.

**Pressure Rating:**

Schedule 40 PVC Fittings:  
Water Pressure rating (max) for PVC schedule 40 fittings at 73° F (23°C).

**Pressure Rating:**

Schedule 80 PVC and CPVC Fittings:  
Water Pressure rating (max) for PVC and CPVC fittings sch.80 at 73° F (23°C).

**Table - 2**

Pipe Size Inch.	Socket Fittings (psi)
1/2	600
3/4	480
1	450
1 1/4	370
1 1/2	330
2	280

**Table - 3**

Pipe Size Inch.	Socket Fittings (psi)	Threaded Fittings (psi)
1/2	850	420
3/4	690	340
1	630	320
1 1/4	520	260
1 1/2	470	240
2	400	200



# TEMPERATURE PRESSURE RELATIONSHIP

With an increase of operating temperature, pressure ratings must be reduced accordingly as indicated below

**Table - 4** At Temperature 73°F(23°C)

	Temperature	Derating
Schedule 40 PVC Fittings	80° F	90 % of rated pressure at 73° F
	100° F	62 % of rated pressure at 73° F
	120° F	40 % of rated pressure at 73° F
	140° F	22 % of rated pressure at 73° F
Schedule 80 PVC Fittings	80° F	90 % of rated pressure at 73° F
	90° F	75 % of rated pressure at 73° F
	100° F	62 % of rated pressure at 73° F
	110° F	50 % of rated pressure at 73° F
	120° F	40 % of rated pressure at 73° F
	130° F	30 % of rated pressure at 73° F
	140° F	20 % of rated pressure at 73° F
Schedule 80 cPVC Fittings	80° F	96 % of rated pressure at 73° F
	100° F	83 % of rated pressure at 73° F
	120° F	70 % of rated pressure at 73° F
	140° F	55 % of rated pressure at 73° F
	160° F	40 % of rated pressure at 73° F
	180° F	25 % of rated pressure at 73° F
	200° F	18 % of rated pressure at 73° F

## SOLVENT CEMENT WELDING

This method of joining is very simple and reliable if it is followed correctly, but any deviations from the recommended basic steps may reduce the strength and integrity of the joint. The procedures for preparation, insertion, and curing should be followed very carefully. For further details consult National Marketing Co.

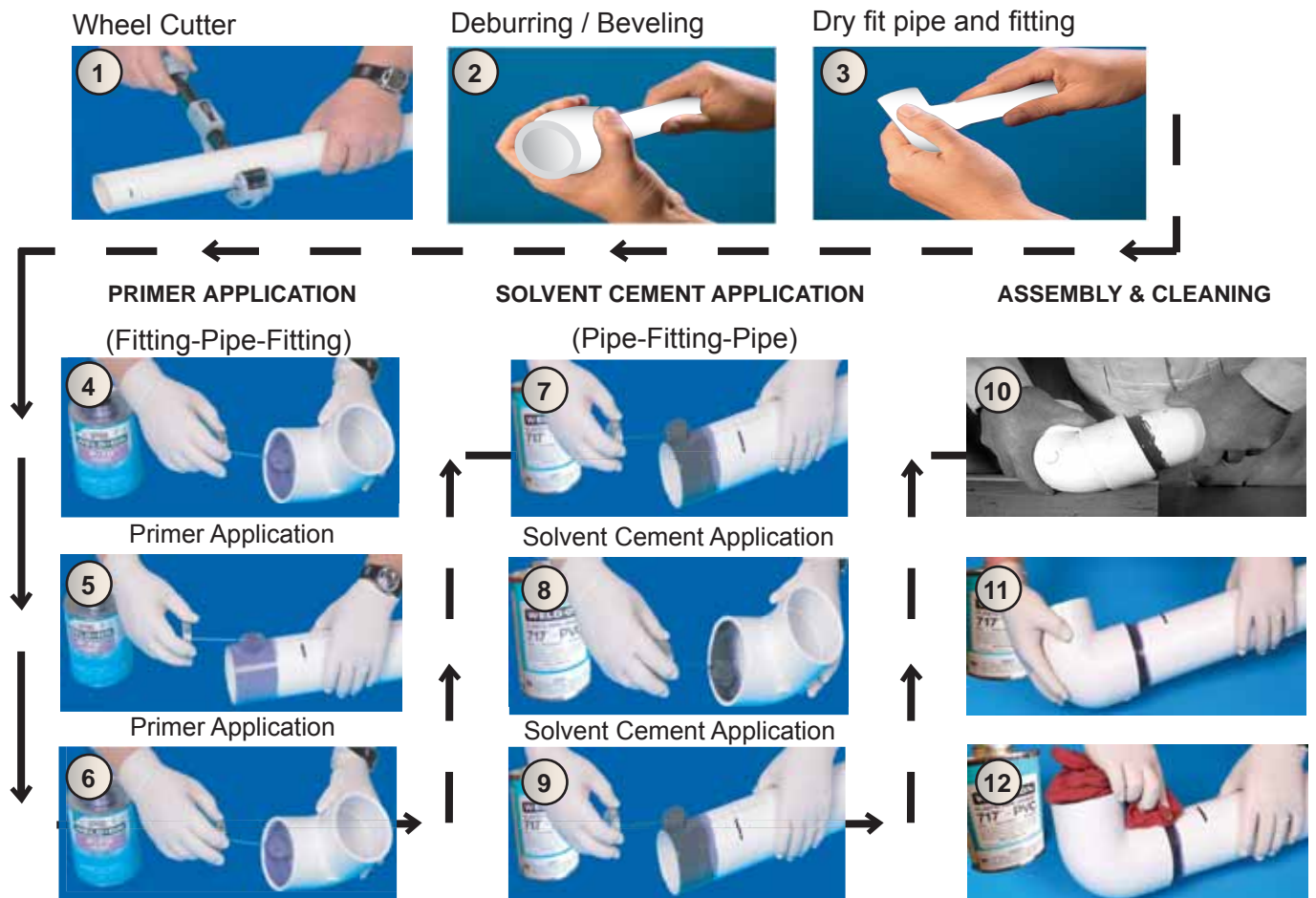

## INSTALLATION & ADVANTAGES

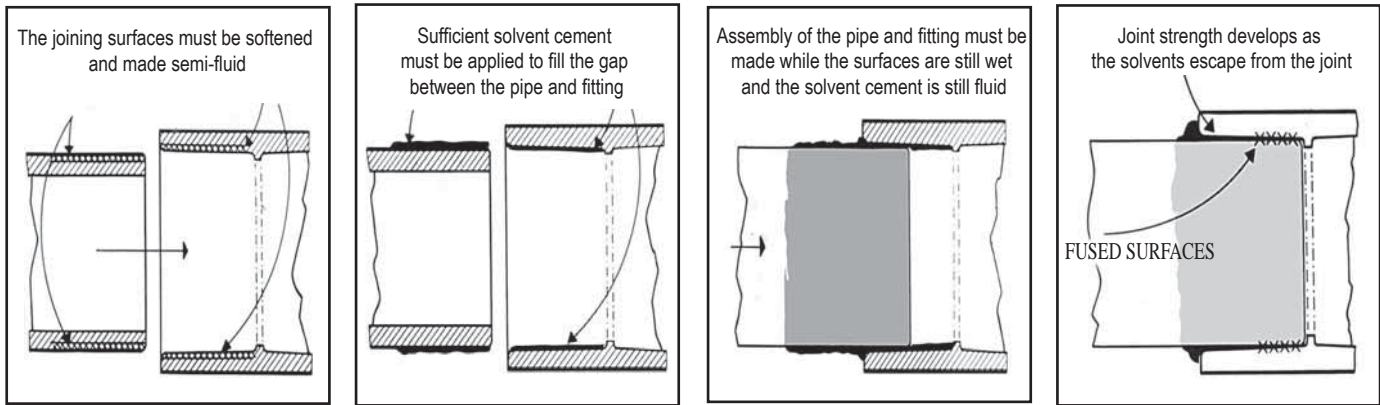

### Safety Precautions

Solvent cement and primer contain highly volatile solvents. Use them in a well ventilated area, keep away from naked flames, avoid smoking, switch off unprotected electrical apparatus and electric heaters, discontinue any welding operations, observe all instructions issued by solvent cement manufacturer & always obey the safety regulations issued by the authorities responsible.

### Advantages of Primer:

- Penetrates the surface preparing for the 'fusion'.
- Softens the surfaces faster than solvent cement alone
- For Schedule 80 pressure applications.
- On hard surfaces, like CPVC
- In cold temperatures

## ADVANTAGES OF NEPROPLAST PVC & cPVC FITTINGS

The group of materials known as unplasticized PVC is one of the most important developments of the last few decades as it reduces the cost and improves the reliability of pipeline installations. The properties can be varied by small additions of modifying agents which have definite and controlled mechanical properties. They can be fabricated to close dimensional tolerances, light without being weak, rigid without being brittle.

### Corrosion Resistance & Scale Build up:

NEPROPLAST PVC & cPVC Fittings are chemically resistant to nearly all acids, alkalis, alcohols, halogens as well as many other corrosive fluids. Being non-conductor of electricity, it eliminates galvanic or electrolytic corrosion which is the cause of expensive repairs. NEPROPLAST PVC & cPVC non-corroding properties ensure improved flow, lower maintenance costs and longer performance life.

### Fire Proof:

NEPROPLAST PVC & cPVC Fittings do not support combustion and are self extinguishing. Pipes will not burn unless an external flame source is applied. NEPROPLAST PVC & cPVC Fittings are non-toxic and will not affect taste, smell or color of drinking water or any other liquid. Extensive tests on PVC & cPVC compounds prove their outstanding fire performance.

### Reduced Additive migration

NEPROPLAST PVC & cPVC Fittings do not allow migration of additives into water supply and hence no bad odour or taste of drinking water.

### Ease of Handling, Installation & Maintenance:

NEPROPLAST PVC & cPVC Fittings pipes are quick and easy to install and maintained with complete range of solvent cement fittings saving time, effort and money as it is light in weight, and easy to handle.

### Chemical Resistance:

NEPROPLAST PVC & cPVC Fittings inhibit excellent chemical resistance against most acids, alcohols, alkalis, salt solutions and halogens. NEPROPLAST PVC & cPVC Fittings are also not adversely affected by atmospheric conditions and are well suited for outdoor installations. For specific applications see the NEPROPLAST chemical resistance guide.

### Low Bacteria Build up:

Studies shows that bacteria build up with NEPROPLAST PVC & cPVC Fittings are far lower than with alternative piping materials. NEPROPLAST PVC & cPVC Piping systems are resistant to fungi and bacterial growth, particularly those which cause corrosion in metal piping systems.



# ADVANTAGES & PHYSICAL PROPERTIES

## Thermal Conductivity

NEPROPLAST PVC & cPVC Fittings have lower thermal conductivity than for metal which reduces heat losses (essentially acts as an insulator) and offer better uniform fluid temperature, prevent "sweating" formation of condensation on the pipe wall. Insulation in certain instances, may be completely eliminated.

## Fluid Friction:

NEPROPLAST PVC & cPVC Fittings being a mirror-smooth inner surface has lower friction loss as compared to metals, i.e Lower pressure losses.

## PHYSICAL PROPERTIES

**Table No - 5**

	UNIT	PVC	CPVC	ASTM TEST
Specific Gravity	g/cc	1.40-1.43	1.52-1.55	D-792
Cell Designation		12454B	23447	D-1784
MECHANICAL	UNIT	PVC	CPVC	ASTM TEST
Izod Impact	J/m of notch	34.7	80.1	D-256
@ 23 <sup>0</sup> C (73 <sup>0</sup> F)	ft. lb/in of notch	0.65	1.6	
Tensile Strength	Mpa	48.3	55.2	D-638
@ 23 <sup>0</sup> C (73 <sup>0</sup> F)	Psi	7000	8000	
Modulus of Elasticity	Mpa	2758	2482	D-638
in Tension @ 23 <sup>0</sup> C (73 <sup>0</sup> F)	Psi	400,000	360,000	
Flexural Strength	Mpa	87.6	104.1	
@ 23 <sup>0</sup> C (73 <sup>0</sup> F)	Psi	12700	15000	D-790
Relative Hardness	Rockwell "R"	120	119	D-785
@ 23 <sup>0</sup> C (73 <sup>0</sup> F)				
THERMODYNAMICS	UNIT	PVC	CPVC	ASTM TEST
Thermal Conductivity	Wm/ <sup>0</sup> k	0.17	0.14	ASTM C177
	Btu.in/hr/ft <sup>2</sup> / <sup>0</sup> F	1.2	0.95	
Heat Deflection Temperature @ 1.82 Mpa(264 psi)	<sup>0</sup> C	71.1	103	ASTM D-648
	<sup>0</sup> F	160	217	
Maximum operating Temperature	<sup>0</sup> C	60	93	
	<sup>0</sup> F	140	210	
ELECTRICAL	UNIT	PVC	CPVC	ASTM TEST
Dielectric Strength	KV	55	49	D-147
	mm			
	V			
	Mil	1400	1250	
Volume Resistivity @ 23 <sup>0</sup> C (73 <sup>0</sup> F)	Ohm-cm	3.5x10 <sup>15</sup> "	3.4x10 <sup>15</sup>	D-257
	Ohm-inch	899x10 <sup>12</sup> "	1.3384	



# SCHEDULE 80 PVC & cPVC FITTINGS

## Male Adapters

**PVC Male Adapters**  
Fig : A

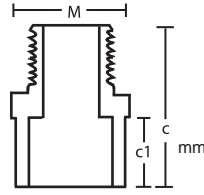

**cPVC Male Adapters**  
Fig : B



Nominal Pipe Size In.	PVC Code Number	mm			cPVC Code Number	Nominal Pipe Size In.
		C	C1	M		
1/2	124SN - K12	47.70	23.25	29.85	244SN / K12	1/2
3/4	124SN - K34	52.80	26.05	37.75	244SN / K34	3/4
1	124SN - K1	61.70	29.60	43.50	244SN / K1	1
1 1/4	124SN - K114	65.09	32.15	52.39	244SN / K114	1 1/4
1 1/2	124SN - K112	68.26	35.32	59.93	244SN / K112	1 1/2
2	124SN - K2	73.82	38.89	73.42	244SN / K2	2



## Elbows (90°)

**PVC Elbow 90°**  
Fig : A

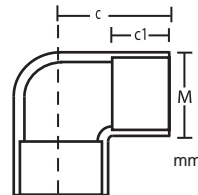

**cPVC Elbow 90°**  
Fig : B



Nominal Pipe Size In.	PVC Code Number	mm			cPVC Code Number	Nominal Pipe Size In.
		C	C1	M		
1/2	124SN - G12	36.10	23.00	29.80	244SN/G12	1/2
3/4	124SN - G34	40.55	26.25	35.60	244SN/G34	3/4
1	124SN - G1	46.96	29.90	43.70	244SN/G1	1
1 1/4	124SN - G114	54.77	32.54	53.98	244SN/G114	1 1/4
1 1/2	124SN - G112	60.72	25.32	60.72	244SN/G112	1 1/2
2	124SN - G2	69.85	38.89	73.03	244SN/G2	2



## Tee (90°)

**PVC Tee 90°**  
Fig : A

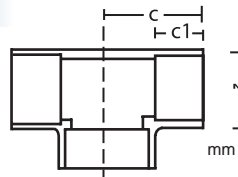

**cPVC Tee 90°**  
Fig : B



Nominal Pipe Size In.	PVC Code Number	mm			cPVC Code Number	Nominal Pipe Size In.
		C	C1	M		
1/2	124SN - T12	37.09	23.00	29.80	224SN/T12	1/2
3/4	124SN - T34	41.18	26.25	35.60	224SN/T34	3/4
1	124SN - T1	47.66	29.90	43.70	224SN/T1	1
1 1/4	124SN - T114	54.77	32.54	53.98	224SN/T114	1 1/4
1 1/2	124SN - T112	61.12	25.32	60.72	224SN/T112	1 1/2
2	124SN - T2	71.83	38.89	73.03	224SN/T2	2



## Couplings

**PVC Couplings**  
Fig : A

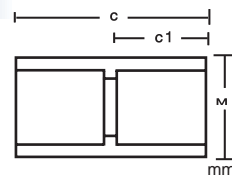

**cPVC Couplings**  
Fig : B



Nominal Pipe Size In.	PVC Code Number	mm			cPVC Code Number	Nominal Pipe Size In.
		C	C1	M		
1/2	124SN - M12	49.40	23.40	33.45	224SN/M12	1/2
3/4	124SN - M34	55.55	26.20	37.75	224SN/M34	3/4
1	124SN - M1	63.00	30.30	45.30	224SN/M1	1
1 1/4	124SN - M114	67.47	32.14	53.18	224SN/M114	1 1/4
1 1/2	124SN - M112	74.71	35.32	60.32	224SN/M112	1 1/2
2	124SN - M2	80.56	38.10	73.42	224SN/M2	2





# SCHEDULE 80 PVC & cPVC FITTINGS

## Unions



Fig: A

**PVC Unions**  
Fig : A

Nominal Pipe Size In.	PVC Code Number	mm			cPVC Code Number	Nominal Pipe Size In.
		C	C1	M		
1/2	124SN - B12	53.00	22.65	32.20	224SN/B12	1/2
3/4	124SN - B34	62.20	26.00	38.00	224SN/B34	3/4
1	124SN - B1	67.50	29.10	41.00	224SN/B1	1
1 1/4	124SN - B114	74.35	32.70	55.85	224SN/B114	1 1/4
1 1/2	124SN - B112	82.40	36.00	60.70	224SN/B112	1 1/2
2	124SN - B2	94.00	39.00	75.80	224SN/B2	2

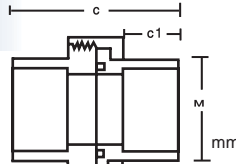

**cPVC Unions**  
Fig : B



Fig: B

## Threaded Elbows



Fig: A

**PVC Threaded Elbows**  
Fig : A

Nominal Pipe Size In.	PVC Code Number	mm			cPVC Code Number	Nominal Pipe Size In.
		C	C1	M		
1/2	124SN - GF12	31.75	19.30	32.09	244SN/GF12	1/2
3/4	124SN - GF34	34.70	19.05	35.50	244SN/GF34	3/4

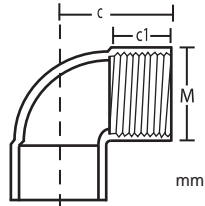

**cPVC Threaded Elbows**  
Fig : B



Fig: B

## Threaded Tee (90°)



Fig: A

**PVC Treaded Tee 90°**  
Fig : A

Nominal Pipe Size In.	PVC Code Number	mm			cPVC Code Number	Nominal Pipe Size In.
		C	C1	M		
1/2	124SN - TF12	37.09	23.60	29.75	224SN/TF12	1/2
3/4	124SN - TF34	41.18	26.50	35.60	224SN/TF34	3/4

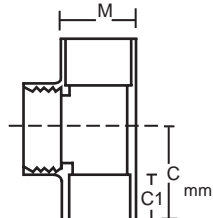

**cPVC Treaded Tee 90°**  
Fig : B



Fig: B



# SCHEDULE 80 PVC & cPVC FITTINGS

## Tee Brass Insert



**PVC Tee Brass Insert  
Fig : A**

Nominal Pipe Size In.	PVC Code Number	mm		
		C	M1 In	M2
1/2x1/2x1/2	144SN-TF12BR	29.85	1/2	37.80
3/4x3/4x3/4	144SN-TF34BR	35.54	3/4	45.00
3/4x1/2x3/4	144SN-TF34x12BR	35.54	1/2	37.80

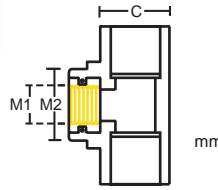

**cPVC Tee Brass Insert  
Fig : B**

Nominal Pipe Size In.	cPVC Code Number	mm		
		C	M1 In	M2
1/2x1/2x1/2	244SN/TF12BR	29.85	1/2	37.80
3/4x3/4x3/4	244SN/TF34BR	35.54	3/4	45.00
3/4x1/2x3/4	244SN/TF34x12BR	35.54	1/2	37.80



## Male Adapters Brass Insert



**PVC Male Adapters  
Brass Insert Fig : A**

Nominal Pipe Size In.	PVC Code Number	mm		
		C	M In	C1
1/2 x 1/2	143SN-K12BR	44.22	1/2	29.74
3/4 x 3/4	143SN-K34BR	48.40	3/4	35.47
1 x 1	143SN-K1BR	54.78	1	43.24

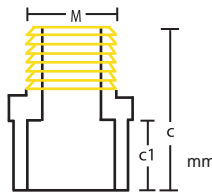

**cPVC Male Adapters  
Brass Insert Fig : B**

Nominal Pipe Size In.	cPVC Code Number	mm		
		C	M In	C1
1/2 x 1/2	243SN/K12BR	44.22	1/2	29.74
3/4 x 3/4	243SN/K34BR	48.40	3/4	35.47
3/4 x 1/2	243SN/K1BR	54.78	1	43.24



## Female Adapters Brass Insert



**PVC Female Adapters Brass  
Insert Fig : A**

Nominal Pipe Size In.	PVC Code Number	mm		
		C	M1 In	M2
1/2 x 1/2	144SN-F12BR	29.85	1/2	37.80
3/4 x 1/2	144SN-F34x12BR	35.54	1/2	37.80

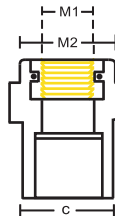

**cPVC Female Adapters Brass  
Insert Fig : B**

Nominal Pipe Size In.	cPVC Code Number	mm		
		C	M1 In	M2
1/2 x 1/2	244SN/F12BR	29.85	1/2	37.80
3/4 x 1/2	244SN/F34BR	35.54	1/2	37.80



## Elbows (90°)



**PVC Elbow Brass Insert  
Fig : A**

Nominal Pipe Size In.	PVC Code Number	mm		
		C	M1 In	M2
1/2 x 1/2	144SN-GF12BR	29.85	1/2	37.80
3/4 x 3/4	144SN-GF34BR	35.54	3/4	45.0
3/4 x 1/2	144SN-GF34x12BR	35.54	1/2	37.80

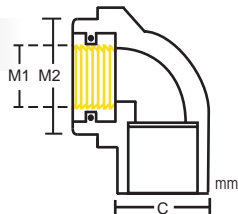

**cPVC Elbow Brass Insert  
Fig : B**

Nominal Pipe Size In.	cPVC Code Number	mm		
		C	M1 In	M2
1/2 x 1/2	244SN/GF12BR	29.85	1/2	37.80
3/4 x 3/4	244SN/GF34BR	35.54	3/4	45.0
3/4 x 1/2	244SN/GF34x12BR	35.54	1/2	37.80



# SCHEDULE 40 PVC FITTINGS

## Elbows (90°)

### PVC Elbows (90°)

Fig : A



Fig: A

Nominal Pipe Size In.	Code Number	C	C1	M
		mm	mm	mm
1/2	123SN.G12	33.93	19.65	27.60
3/4	123SN.G34	40.45	24.95	33.30
1	123SN.G1	45.11	27.65	40.70
1 1/4	123SN.G114	55.26	31.05	49.90
1 1/2	123SN.G112	60.00	33.40	56.20
2	123SN.G2	66.49	33.95	68.65

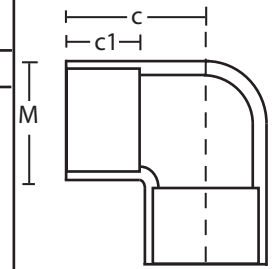

## Tees

### PVC Tees

Fig : A



Fig: A

Nominal Pipe Size In.	Code Number	C	C1	M
		mm	mm	mm
1/2	123SN.T12	31.65	19.65	27.70
3/4	123SN.T34	40.05	25.80	32.90
1	123SN.T1	44.30	28.10	41.30
1 1/4	123SN.T114	54.50	31.40	49.90
1 1/2	123SN.T112	60.15	33.90	56.20
2	123SN.T2	67.35	34.45	68.60

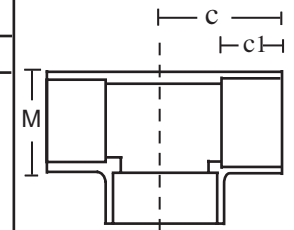

## Couplings

### PVC Couplings

Fig : A



Fig: A

Nominal Pipe Size In.	Code Number	C	C1	M
		mm	mm	mm
1/2	123SN.M12	53.00	19.84	28.57
3/4	123SN.M34	62.20	19.84	34.95
1	123SN.M1	67.50	25.90	41.27
1 1/4	123SN.M114	74.35	26.98	50.8
1 1/2	123SN.M112	82.40	30.16	57.15
2	123SN.M2	94.00	38.70	69.04

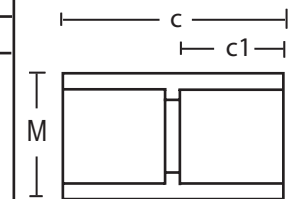

## Male Adapters

### PVC Male Adapters

Fig : A



Fig: A

Nominal Pipe Size In.	Code Number	C	C1	M
		mm	mm	mm
1/2	123SN.K12	41.60	18.85	27.60
3/4	123SN.K34	48.35	25.50	33.30
1	123SN.K1	59.70	28.35	40.75
1 1/4	123SN.K114	210.9	93.75	145.3
1 1/2	123SN.K112	293.75	112.5	223.4
2	123SN.K2	254.7	117.18	273.43

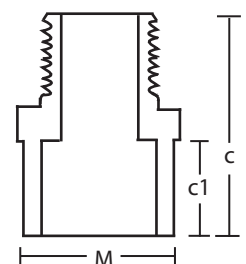

# SCHEDULE 40 PVC FITTINGS

## Unions

### PVC Unions

Fig : A



Fig: A

Nominal Pipe Size In.	Code Number	C	C1	M
		mm	mm	mm
1/2	123SN.B12	60.33	23.02	30.16
3/4	123SN.B34	65.88	25.40	35.72
1	123SN.B1	73.03	29.37	42.86
1 1/4	123SN.B114	85.73	32.54	53.98
1 1/2	123SN.B112	98.43	35.72	60.33
2	123SN.B2	111.13	38.10	73.03

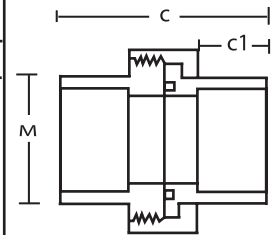

## Threaded Elbows

### PVC Threaded Elbows

Fig : A



Fig: A

Nominal Pipe Size In.	Code Number	C	C1	M
		mm	mm	mm
1/2	123SN.GF12	31.65	19.65	27.70
3/4	123SN.GF34	40.05	25.80	32.90
1	123SN.GF1	44.30	28.10	41.30
1 1/4	123SN.GF114	54.50	31.40	49.90
1 1/2	123SN.GF112	60.15	33.90	56.20
2	123SN.GF2	67.35	34.45	68.60

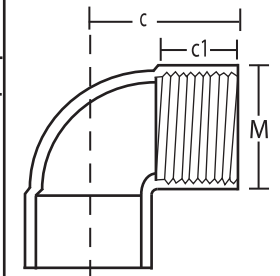

## Female Adapters Brass Insert

### PVC Female Adapters

Brass Insert Fig : A



Fig: A

Nominal Pipe Size In.	Code Number	C	M1	M2
		mm	In	mm
1/2 x 1/2	144SN.F12BR	29.85	1/2	37.80
3/4 x 1/2	144SN.F34BR	35.54	1/2	37.80

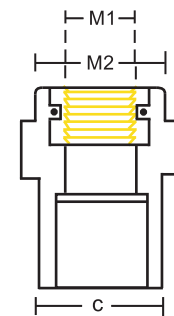

# NAMAT DRAINAGE FITTINGS

## Wye 45°



Fig: A

Nominal Pipe Size In.	Code Number	C	C1	M
		mm	mm	mm
2	126SNWY2	165.5	69.01	111.31
4	126SNWY4	292.9	126.80	204.15

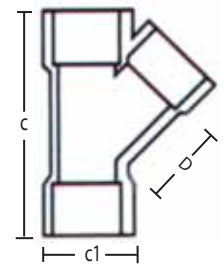

## Tee 90°



Fig: A

Nominal Pipe Size In.	Code Number	C	C1	M
		mm	mm	mm
4	126SNWT4	110.40	51.30	127.06
6	126SNWT6	76.20	165.20	183.05
4x2	126SNWT4x2	50.80	165.20	126.80
6x4	126SNWT6x4	76.20	165.20	183.05

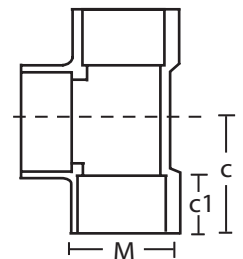

## Elbow 90°



Fig: A

Nominal Pipe Size In.	Code Number	C	C1	M
		mm	mm	mm
3	126SNWG3	95.20	47.60	120.28
4	126SNWG3	109.44	51.50	127.40

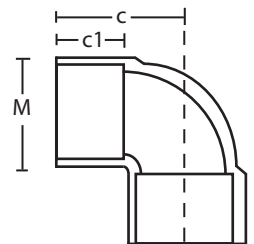

## Elbow 45°



Fig: A

Nominal Pipe Size In.	Code Number	C	C1	M
		mm	mm	mm
2	126SNWH2	30.00	45.60	68.65
3	126SNWH3	47.60	70.00	100.20
4	126SNWH4	110.40	97.10	127.06
6	126SNWH6	77.00	160.00	183.50

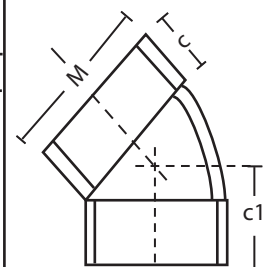

## Coupling



Fig: A

Nominal Pipe Size In.	Code Number	C	C1	M
		mm	mm	mm
4	126SNWM4	10.60	5.20	12.80
6	126SNWM6	18.15	9.00	18.30

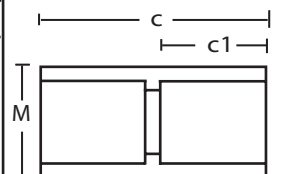

# NAMAT DRAINAGE FITTINGS

## Access Tee



Nominal Pipe Size In.	Code Number	C	C1	M	C2
		mm	mm	mm	mm
4	126SNWAT4	221.60	51.05	127.65	27.70

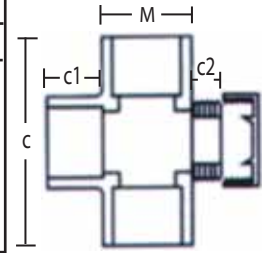

## Access Elbow 90°



Nominal Pipe Size In.	Code Number	C	C1	M	M
		mm	mm	mm	mm
4	126SNWAG4	27.00	51.70	126.85	102.06

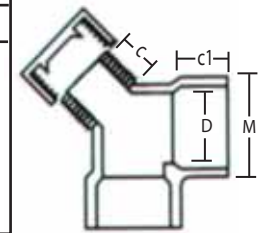

## P-Trap



Nominal Pipe Size In.	Code Number	C	C1	M
		mm	mm	mm
4	126SNWPT4	51.8	45.8	127.05
110mm	126SNWPT110	51.8	45.8	127.05
110/4	126SNWPT4.4	58.05	47.05	127.05

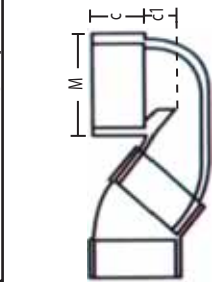

## PVC Floor Gully



Nominal Pipe Size In.	Code Number	C	C1	M
		mm	mm	mm
3x2x1 1/2	126SNWFG3x2x112	121.35	120.4	52.55

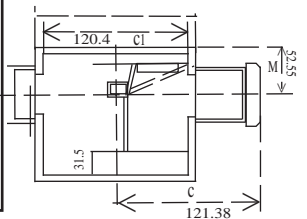

## Access Cap and Plug



Nominal Pipe Size In.	Code Number	A	B	D
		mm	mm	mm
2	126SNWAP2	49.15	70.65	59.90
3	126SNWAP3	59.70	98.10	88.90
4	126SNWAP4	71.65	125.85	88.90
6	126SNWAP6	113.75	187.80	168.50

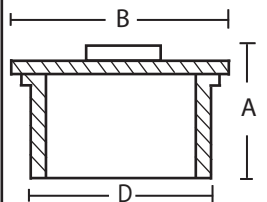

# NEPROPLAST

Manufacturing Plant, JEDDAH  
P.O. Box 460 - zip Code 21411  
Tel.: 02-6363558/1596/1205 Fax: 02-6362364  
Email : info@neproplast.com

## MARKETING OFFICES

### • Eastern Region

National Marketing Est Co. Ltd.  
Dammam  
P.O. Box 2145 - zip code 31952.  
Tel.: 03 847-1315  
Fax: 03 847-1312  
E-mail : dammam@namat.com

National Marketing Est Co. Ltd. Dammam  
(Saud Branch)  
P.O. Box 2145 - zip code 31952  
Tel.: 03 834-4904  
Fax: 03 834-5247  
E-mail : dammam@namat.com

National Marketing Est Co. Ltd. Al-Ahsa  
P.O. Box 4251, Al Ahsa 31982  
Tel.: 03 580-0699 / 5885682  
Fax: 03 588-5681  
E-mail : alahsa@namat.com

National Marketing Est Co. Ltd.  
Jubail : 31951  
P.O.Box : 810  
Tel:03 3612159 , Fax: 03 3612155  
Email: jubail@namat.com

National Marketing Est Co. Ltd..  
Hafr Btain 31991  
Tel.: 03 723-5200  
Fax: 03 723-5240  
E-mail : hafraibaten@namat.com

National Marketing Est Co. Ltd. Khafji  
Jubail : 31951 , P.O.Box : 810  
Tel:03 7670557 , Fax: 03 7671146  
Email: khafji@namat.com

### • Central Region

National Marketing Est Co.Ltd.  
Riyadh  
P.O.Box 60738-Zip Code 11555  
Tel.: 01 478 0015 / 477 3378  
Fax: 01 482567  
E-mail : Riyadh@namat.com

National Marketing Est Co. Ltd.Al-Kharj  
P.O. Box 2589 , Al-Kharj 11942  
Tel.: 01 548 9057  
Fax: 01 548 4773  
E-mail : Kharj@namat.com

National Marketing Est Co. Ltd.Qassim  
P.O. Box 2218, Qassim, Buraidah  
Tel.: 06 382-0916 / 381-3350  
Fax: 06 381-3982  
E-mail : qassim@namat.com

National Marketing Est Co. Ltd.Hail  
P.O. Box 7479 , Hail  
Tel.: 06 533-0476  
Fax: 06 534-4248  
E-mail : hail@namat.com

National Marketing Est Co. Ltd.Arar  
P.O. Box 1251 , Arar 91431  
Tel.: 04 664 2529  
Fax: 04 662 1626  
E-mail : arar@namat.com

National Marketing Est Co. Ltd. Wadi Dawasser  
P.O.Box : 2589 , Al - Kharj : 11942  
Tel: 01 7861029 , Fax: 01 7861029  
Email: kharj@namat.com

National Marketing Est Co. Ltd. Qurrayat  
P.O.Box : 1251 , Arar : 91431  
Tel: 04 6427779 , Fax: 04 6416233  
Email: arar@namat.com

### • Western Region

National Marketing Est Co. Ltd.  
Jeddah (Bani Malik)  
P.O. Box 16375, Jeddah 21464  
Tel.: 02-617-1655/670-1603  
Fax: 02-673-6384  
E-mail :cont@namat.com

National Marketing Est Co. Ltd. Taif  
King Khaled Street , Beside Al Muhaidib  
Tel. 02 744-1345 , Fax: 02 744-1645  
Email: nader.qrenawi@ikkgroupp.com

National Marketing Est Co. Ltd. Madina  
P.O. Box: 5362 , Al Jamaat Road  
Beside Central Market Al-Dar  
Tel: 04 8500011/8501010/8500505 , Fax: 04 8500165  
Email: madinah@namat.com

National Marketing Est Co. Ltd. Yanbu  
P.O. Box: 773 , Yanbu 41911  
Tel. 04 322 3880 / 3917483 / 390 2372  
Fax: 04 322 3857  
Email: yanbu@namat.com

National Marketing Est Co. Ltd. Tabuk  
Al-Madinah Al-Munawarah Road  
Tel: 04 4230550/04 4232502 , Fax: 04 4215761  
Email: tabuk@namat.com

National Marketing Est Co. Ltd. Jazan  
Sabia City , Dair Baney Malk Street , Jazan  
Tel. 07 3270072 , Fax: 07 3267577  
Email: saher.almossa@ikkgroupp.com

National Marketing Est Co. Ltd. Sabt Al Alaya  
Near Al Farouk Mosque , Sabt Al Alaya  
Tel: 07 6300701 , Fax: 07 6300705  
Email: waheeb.trad@ikkgroupp.com

National Marketing Co.Ltd. Khamis Mushait  
P.O. Box:2819,  
New Khamis Mushait Industrial Area  
Tel. 07 233 0997 / 2382 977 / 887 ,  
Fax: 07 233 0660  
Email : Khamis@namat.com

## Export Offices

National Marketing Est Co. Ltd. Export Office  
P.O. Box 16375 - Zip Code 21464  
Tel.: 02-647-4204  
Fax: 02-647-4503  
E-mail : export@namat.com



**NAMAT**

**نيسروپلاست**

شركة صناعات المنتجات الجديدة المحدودة

قطع توصيلات مياه و صرف صحي  
بي في سي PVC و سي بي في سي cPVC  
مجموعة 40 و 80  
مواصفات امريكي ASTM



التوزيع الحصري  
شركة المؤسسة الوطنية للتسويق المحدودة  
www.namat.com | www.neproplast.com  
www.namat-plasticwelding.com

